



**SIGNATURE<sup>®</sup>  
GLOBAL**  
MAKING INDIA AFFORDABLE

An ISO 9001:2015; 14001:2015; 45001:2018 Certified Company

**INDIA'S NO. 1  
AFFORDABLE HOUSING COMPANY**



# ABOUT SIGNATURE GLOBAL

Signature Global believe in the policy of transparency.

We emphasize on the core values of reliability, responsibility and global standards with regard to the International Real Estate realm.

The group has outlined its vision for 'India of Tomorrow' with a mission of 'Har Parivar ek Ghar' (A home for every family).

# REALTY • RELIABILITY • RESPONSIBILITY

Company Backed by  
**IFC** – An arm of **World Bank**



*Creating Markets, Creating Opportunities*

Received **Completion Certificate**  
**before time** for similar projects  
in **Sohna & Karnal**



**SUNRISE**<sup>™</sup>  
THE PREMIUM FLOORS  
BY SIGNATURE GLOBAL



# NO COMPROMISE ON OUR ENVIRONMENTAL RESPONSIBILITIES



The COVID-19 pandemic is threatening health & lives.



United Nation Environment Programme has suggested sustainable development goals for Global recovery with Building & Construction as one of the focus areas.



Signature Global has been in frontline when it comes to adopting Green Building practices

# SIGNATURE GLOBAL IS CERTIFIED AS AN ECOFRIENDLY ORGANIZATION



ISO 14001:2015

For Our promise to take care of environment around us or effected by us  
(directly/ indirectly)



We have launched 7 IGBC Gold Rated projects under Affordable Housing



The DDJAY luxury floors projects are all going to be EDGE certified  
(International Green certification). We are the 1<sup>st</sup> Affordable Housing  
Developer to achieve EDGE preliminary certification



**FINALLY**  
**THE WAIT IS OVER**

**RERA REGISTRATION NO.:**

RC/REP/HARERA/GGM/477/209/2021/45

RC/REP/HARERA/GGM/478/210/2021/46

([www.haryanarera.gov.in](http://www.haryanarera.gov.in))

# PRESENTING



GURUGRAM'S CROWNING GLORY. IN A GREEN OASIS.



# LOCATION





# 360 DEGREE LOCATION TOOL

<https://www.signatureglobal.in/SignatureGlobalCity81/app-files/>

# WHAT'S SO GREAT ABOUT SECTOR 81 GURUGRAM?

Signature Global offers you a green and healthy life in a sector surrounded with Multiple 'Green - Belts' - Sector 81, Gurugram.



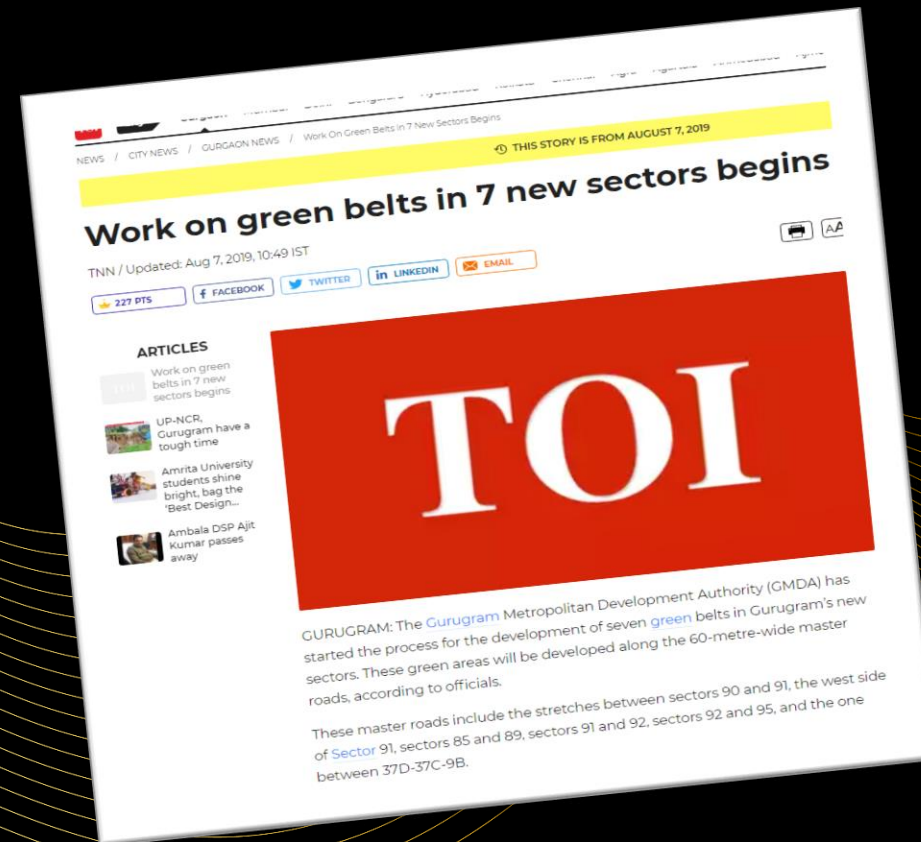

The sector is surrounded by lush greenery providing a serene atmosphere.

# LOCATION ADVANTAGES



- Sector 81 Enjoys Its Proximity To Key Employment Hubs Of The City Like Cyber City, Udyog Vihar, Golf Course Extension Road, Sohna And Manesar.
- Major Industrial Employment Center Of Manesar Is In Close Vicinity.
- The City's Employment Hubs Are Well-connected Through Nh8, Dwarka Expressway And Southern Peripheral Road.
- Another Key Feature Of This Sector That Makes It An Ideal Residential Destination Is Strong Social Infrastructure In The Neighbourhood.

# LOCATION ADVANTAGES



- The Sector Has Witnessed Development Of Several Residential Projects In The Vicinity.
- Residential Projects In These Places Are Ideal For Those Who Choose To Surround Themselves By Abundant Greenery With The Soothing Sound Of Nature.
- Well Established Network Of Schools, Hospitals, Shopping Malls, Retail Markets And Five Star Hotels In The Vicinity.
- The City Is Very Close To The International Airport Via Nh-8 and Dwarka Expressway.
- The Sector Is Well Connected With The Network Of Proposed Metro Line .



**A MONARCH  
OF THE MODERN  
METROPOLIS.**





IN A GREEN OASIS.



DRIVE TO THE CROWN  
OF GURUGRAM, IN  
THE LAP OF NATURE.





BUILDING A RICH  
HERITAGE OF PRISTINE  
GLORY.



DESIGNING AN  
EVERLASTING LOVE  
STORY.



ENJOY WORLD-CLASS  
AMENITIES IN A GREEN  
PARADISE.



AIM, JUMP AND THROW.  
HONE YOUR SKILLS IN  
THIS BASKETBALLCOURT.



KIDS CAN HAVE ALL THE  
FUN AT THE PLAY AREA.



REFRESH WITH A  
REFRESHING DIP AT THE  
SWIMMING POOL.



ENJOY WORLD-CLASS  
AMENITIES IN A GREEN  
PARADISE.



SPEND LEISURE TIME  
IN A GREEN PARADISE.





BUILT TO BE A LEGACY  
OF COMFORT AND  
OPULENCE.



YOUR PERSONAL SPACE  
WHERE YOU CAN  
REJUVENATE IN TRANQUILITY.



A TRENDY LUXURY FOR  
YOUR INNER SANCTUM.



COME, GATHER AROUND THE  
DINING TABLE.  
MAKE A CIRCLE OF FUN,  
FOOD AND FAMILY.



SOAK AND UNWIND IN  
OPULENCE AND STYLE.



MODERN MARVELS IN YOUR  
KITCHEN; FOR SPREADING  
TRADITIONAL WARMTH.



LET THE STORY OF YOUR  
ELEGANCE SPREAD FROM  
YOUR DRAWING ROOM.



WORKING FROM HOME NOW  
GETS MORE CONVENIENT.





COMPLEMENT YOUR HOME  
DECOR WITH A TERRACE  
GARDEN.



FAMILY SHOPPING IS  
REDEFINED AT SIGNUM  
PLAZA 81.



RELAX AND SOCIALIZE IN THE  
ROOFTOP CAFE AT SIGNUM  
PLAZA 81.



DRIVE TO THE CROWN  
OF GURUGRAM, IN  
THE LAP OF NATURE.



# SITE PLAN

**AMENITIES**

- |  |                            |
|--|----------------------------|
| 01. CIRCULAR LANDSCAPE FEATURE WITH PROJECT BRANDING | 14. HALF BASKET BALL COURT |
| 02. WATER FEATURE                                    | 15. BOX CRICKET            |
| 03. ADULT'S SWIMMING POOL                            | 16. SENIOR CITIZEN AREA    |
| 04. JACUZZI  | 17. READING CORNER         |
| 05. KID'S SWIMMING POOL                              | 18. JOGGING TRACK          |
| 06. POOL SIDE DECK                                   | 19. MULTIPURPOSE LAWN      |
| 07. KID'S PLAY AREA                                  | 20. STROLLING PATH         |
| 08. TODDLER'S PLAY AREA                              | 21. FRAGRANCE GARDEN       |
| 09. OUTDOOR GYM                                      | 22. BUTTERFLY GARDEN       |
| 10. STEPPING STONE PATHWAY                           | 23. ORCHARD                |
| 11. AMPHITHEATRE                                     | 24. VEGETABLE GARDEN       |
| 12. YOGA/ MEDITATION LAWN                            | 25. TRELLIS SEATING        |
| 13. MULTIPURPOSE COURT                               |                            |

**HARDSCAPE**

- | LEGEND | DESCRIPTION                               |
|--------|---|
|        | PATHWAY                                   |
|        | JOGGING TRACK                             |
|        | WATER FEATURE FINISHED IN PORCELAIN TILES |
|        | SYNTHETIC SURFACE FOR KID'S PLAY          |
|        | ENTRY/ EXIT                               |

**SOFTSCAPE**

- | LEGEND | DESCRIPTION      |
|--------|------------------|
|        | LAWN             |
|        | PLANTING SHRUBS  |
|        | FOLIAGE TREES    |
|        | ORNAMENTAL TREES |



**LEGEND OF BLOCKS :**

- BLOCK - LILY
- BLOCK - DAFFODILS

# LAYOUT PLANS

Type - A

192 Units

Open For BOOKING



**TYPE-A (3BHK+2T)**  
PLOT SIZE: 117.248 SQ.M

\*FOR PRESENTATION PURPOSE ONLY



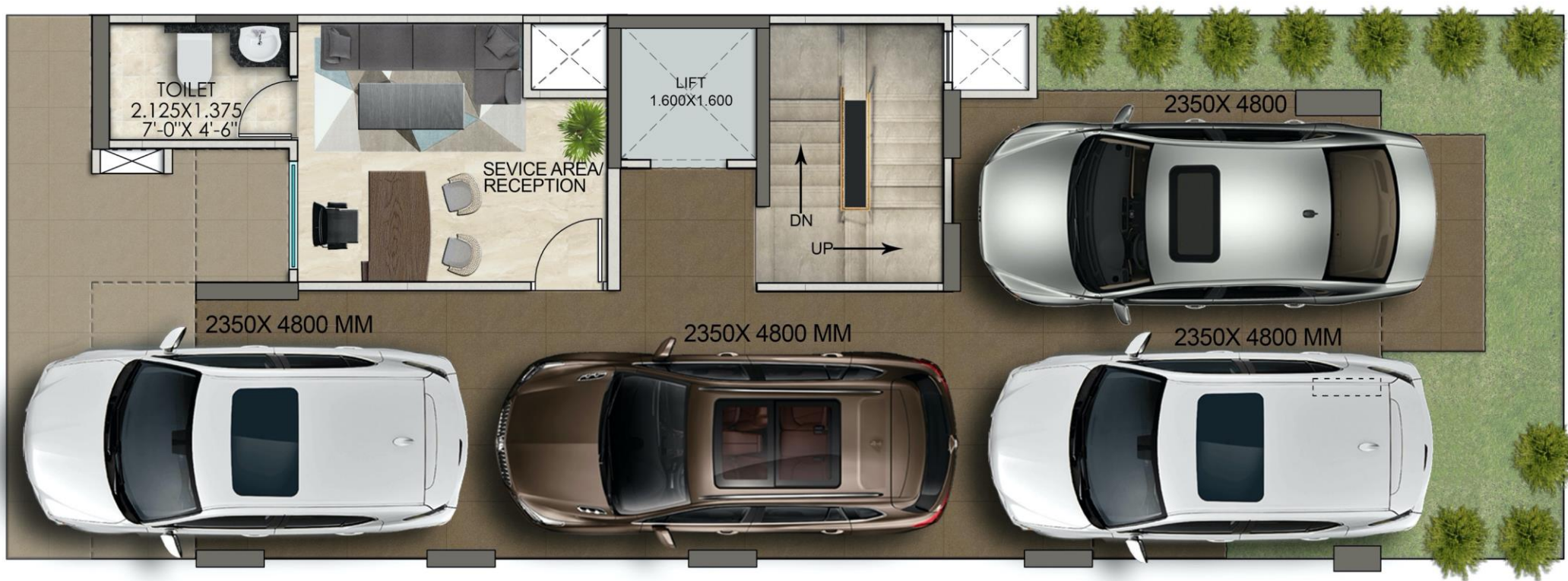

T Y P E - A STILT FLOOR PLAN

\*FOR PRESENTATION PURPOSE ONLY



Type A - Additional Space For Work From Home

BUILTUP AREA - 101.248 SQ. MT.

\*FOR PRESENTATION PURPOSE ONLY

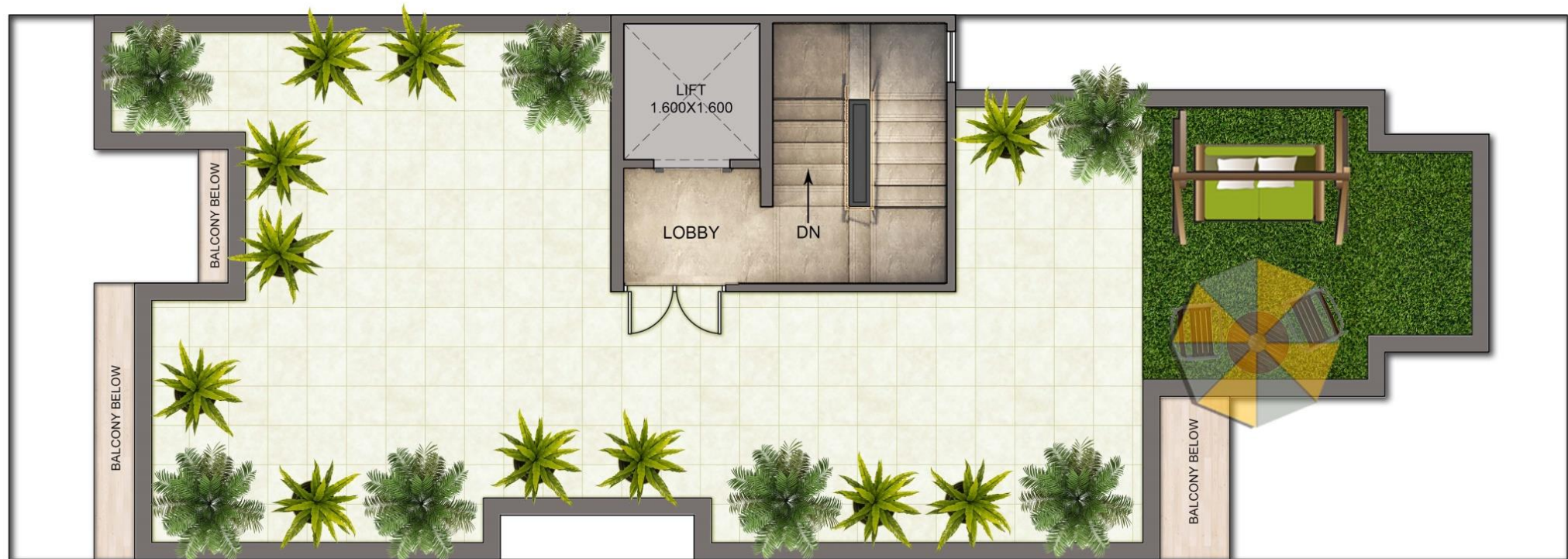

**TERRACE FLOOR PLAN**  
**BUILTUP AREA - 64.15 SQ.MT**

**TYPE-A**

\*FOR PRESENTATION PURPOSE ONLY

# LAYOUT PLANS

Type - B

228 Units

Open For BOOKING



**TYPE-B (2BHK+2T)**

PLOT SIZE: 101.12 SQ.M

\*FOR PRESENTATION PURPOSE ONLY



**T Y P E - B STILT FLOOR PLAN**

\*FOR PRESENTATION PURPOSE ONLY



Type B - Additional Space For Work From Home

BUILTUP AREA - 85.12 SQ.MT.

\*FOR PRESENTATION PURPOSE ONLY



**TERRACE FLOOR PLAN**  
**BUILTUP AREA - 53.74 SQ.MT**

**TYPE-B**

\*FOR PRESENTATION PURPOSE ONLY



# INVENTORY DETAILS

TOTAL AREA: 11.9778 acres	
UNITS OPEN FOR BOOKING	
TYPE A	192
TYPE B	228
TOTAL	420 Units

**QR CODE** - Choose Convenient mode of Payment



**Launching with Payment Gateway. Log on to**

<https://payment.signatureglobal.in/City81/FillApplication.aspx>

# SPECIFICATIONS

## DRAWING / DINING ROOM



FLOOR  
VITRIFIED TILES



CEILING  
OIL BOUND DISTEMPER



WALL  
ACRYLIC EMULSION

## BALCONIES



FLOOR  
ANTI-SKID / MATT  
FINISH CERAMIC TILES



RAILING  
WROUGHT IRON RAILING

## BEDROOM

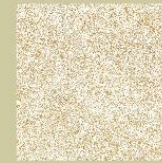

FLOOR  
VITRIFIED TILES



CEILING  
OIL BOUND DISTEMPER



WALL  
ACRYLIC EMULSION

## TERRACE



BRICKBAT COBA OR  
WATER PROOFING TREATMENT

## KITCHEN



FLOOR  
VITRIFIED /  
CERAMIC TILES



WALL / CEILING  
OIL BOUND DISTEMPER



DADO  
CERAMIC TILES 600 MM  
ABOVE THE COUNTER



COUNTER TOP  
GRANITE STONE



FITTINGS & FIXTURES  
ISI MARKED CP FITTINGS  
& SS SINK

## TOILET & BATH



FLOOR  
ANTI-SKID  
CERAMIC TILES



WALL  
CERAMIC TILES TILL  
4 FEET / 7'-0" FEET



CEILING  
GRID FALSE CEILING



FITTINGS & FIXTURES ISI MARKED  
CP FITTINGS, WC & WASHBASIN



MAIN / INTERNAL DOOR FRAME  
HARD WOOD / RED MERANTI



INTERNAL DOOR SHUTTERS  
BOTH SIDE LAMINATED DOORS



EXTERNAL DOORS & WINDOWS  
UPVC/ALUMINIUM POWDER COATED

## DOORS & WINDOWS

## ELECTRICAL

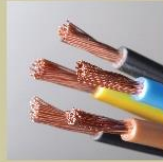

WIRING  
COPPER ELECTRICAL WIRING  
THROUGHOUT IN CONCEALED  
CONDUIT FOR LIGHT POINTS



SWITCHES / SOCKET  
ISI MARKED SWITCHES  
& SOCKETS

## STRUCTURE



EARTHQUAKE RESISTANT  
RCC FRAMED STRUCTURE  
AS PER SEISMIC ZONE

## EXTERNAL DEVELOPMENT



INTERNAL ROADS  
INTERLOCKING BLOCKS/  
TREMIX CONCRETE ROAD



BOUNDARY WALL  
RCC / BRICK WALL  
WITH PLASTER &  
EXTERNAL WEATHER  
PROOF PAINT FINISH



EXTERNAL PAINT  
WEATHER PROOF TEXTURE  
PAINT IN BUILDINGS

Note : Flooring in mix design of marble, granite and tile. Accordingly, variations in shade and/ or size and/or colour and/or design of the tiles, motifs, mica, etc. may occur.



# BEST BRANDS FOR THE BEST EXPERIENCE

## TILES

**Kajaria**  
TRANSFORM YOUR WORLD

**VARMORA**  
Rasoi ki Happiness

**orientbell**  
tiles

## SWITCHES

**legrand**

**Crabtree**

**wipro**

**NORTH-WEST**

## SANITARY FITTINGS

**hindware**  
Start with the expert

**Jaquar**

**KOHLER**

## PLUMBING PIPES

**Supreme**

**ashirvad**

**BIRLA | HIL**  
PIPES

## PAINTS

**asianpaints**

**Dulux**

**Berger**

## WOODEN DOORS

**Bhutan tuff**  
Bringing Home The Nature  
PLY VENEER DOORS

**ramaply**

## KITCHEN SINK

**CARYSIL**  
German Engineered

**Jayna**  
The Kitchen Essentials

## LIGHTING

**wipro**

**OSRAM**

**LEDVANCE**

**SYSKA**

**BAJAJ**  
Bajaj Electronics Ltd.

## DOOR LOCKS & HANDLES

**Dorsët**  
we understand

**quba**  
EXPERIENCE EXCELLENCE

**IPSA**  
DOOR LOCKS | FURNITURE FITTINGS

## WIRES & CABLES

**Finolex**

**HAVELLS**

**POLYCAB**  
Connection Zindagi Ka

## GLASS

**SAINT-GOBAIN**

## UPVC DOORS & WINDOW PROFILES

**KÖMMERLING**

**ÖKOTECH**  
Lead free uPVC profiles

## LIFTS

**OTIS**

**KONE**

**Schindler**

**ECE**  
ELEVATORS  
BIRLA GROUP

**FUJITEC**

**thyssenkrupp**

## CP BATH FITTINGS

**hindware**  
Start with the expert

**Jaquar**

**Kerovit**  
By Kajaria



**PRICE**

---

**TYPE B- 2BHK**

PRICE STARTING FROM

**₹61.91 LAKH\***

+ PARKING + OTHER CHARGES + TAXES

---

---

**TYPE A- 3BHK**

PRICE STARTING FROM

**₹71.04 LAKH\***

+ PARKING + OTHER CHARGES + TAXES

---



# PAYMENT PLAN



<b>S.NO.</b>	<b>PARTICULARS</b>	<b>(%)</b>
1	At the time of submission of application form or Clearance of Cheque (Whichever is later)	9%
2	On Allotment or 60 days from the submission of application (whichever is earlier)	16%
3	Within 8 months from the Date of Booking or Clearance of Cheque (Whichever is earlier)	25%
4	Within 14 months from the Date of Booking or Clearance of Cheque (Whichever is earlier)	25%
5	Within 20 months from the Date of Booking or Clearance of Cheque (Whichever is earlier)	20%
6	On Offer of Possession	5%

Note:

Payment Plan is effective from 5<sup>th</sup> September'21

Payment Plan is Valid for 6 Months From The Date of Launch



# INAUGURAL OFFERS

---

**INAUGURAL OFFER FOR CUSTOMERS**

**GOLD  
BAR**



**ON EACH BOOKING**

OFFER VALID TILL 15<sup>TH</sup> OCTOBER, 2021

---



**LET'S GROW TOGETHER**



#LIFEATSIGNATUREGLOBAL

INDEPENDENT FLOORS FOR THE INDEPENDENT YOU

**RERA REGISTRATION NO.:**

RC/REP/HARERA/GGM/477/209/2021/45

RC/REP/HARERA/GGM/478/210/2021/46

([www.haryanarera.gov.in](http://www.haryanarera.gov.in))